



Help for non-English speakers

If you need help to understand the information in this policy please contact the school office.

PURPOSE

To ensure school staff understand their supervision and yard duty responsibilities.

SCOPE

This policy applies to all teaching and non-teaching staff at Koo Wee Rup Primary School, including education support staff, casual relief teachers and visiting teachers.

POLICY

Appropriate supervision is an important strategy to monitor student behaviour and enables staff to identify and respond to possible risks at school, as they arise. It also plays a vital role in helping schools to discharge their duty of care to students.

The Principal is responsible for ensuring that there is a well organised and responsive system of supervision and yard duty in place during school hours, before and after school, and on school excursions and camps and other school activities.

School staff are responsible for following reasonable and lawful instructions from the Principal, including instructions to provide supervision to students at specific dates, times and places. Supervision should be undertaken in a way that identifies and mitigates risks to child safety.

Before and after school

Koo Wee Rup Primary School's grounds are supervised by school staff from 8:40am until 3:30pm. Outside of these hours, school staff will not be available to supervise students.

Before and after school – 8:40am to 8:55am and 3:15pm to 3:30pm – 2 staff members will be supervising the basketball playground areas.

Parents and carers will be advised through the Sentral Parent Portal, the School FaceBook page and in newsletters that they should not allow their children to attend Koo Wee Rup Primary School outside of these hours. Families will be encouraged to contact Their Care on 1300 072 410 or via email at info@theircare.com.au more information about the before and after school care facilities available to our school community.

If a student arrives at school before supervision commences at the beginning of the day, the Principal or nominee staff member will, as soon as practicable, follow up with the parent/carer to:

- advise of the supervision arrangements before school
- request that the parent/carer make alternate arrangements.



YARD DUTY AND SUPERVISION POLICY

If a student is not collected before supervision finishes at the end of the day, the Principal or nominee staff member will consider whether it is appropriate to:

- attempt to contact the parents/carers
- attempt to contact the emergency contacts
- place the student in an out of school hours care program (if available and the parent consents)
- contact Victoria Police and/or Child Protection to arrange for the supervision, care and protection of the student.

Yard duty

All teaching and Education Support staff at Koo Wee Rup Primary School are expected to assist with yard duty supervision and will be included in the weekly yard duty timetable.

The Assistant Principal is responsible for preparing and communicating the yard duty roster on a regular basis. At Koo Wee Rup Primary School, school staff will be designated specific yard duty times and areas to supervise throughout the week.

Yard duty zones

The designated yard duty areas for our school as at Term 1, 2024 are indicated in the table below and marked on the map over the page.

Zone	Area
Zone A - BLACK	Playground near Staff Room, small grass section between the Staff Room and the portable classrooms to the tree stump only and the grass section in front of the Bandicoot Area.
Zone B - RED	Administration building deck, asphalt area near Grade 1/2 building and Grade 3/4 portables.
Zone C - GREEN	The Oval including cricket nets.

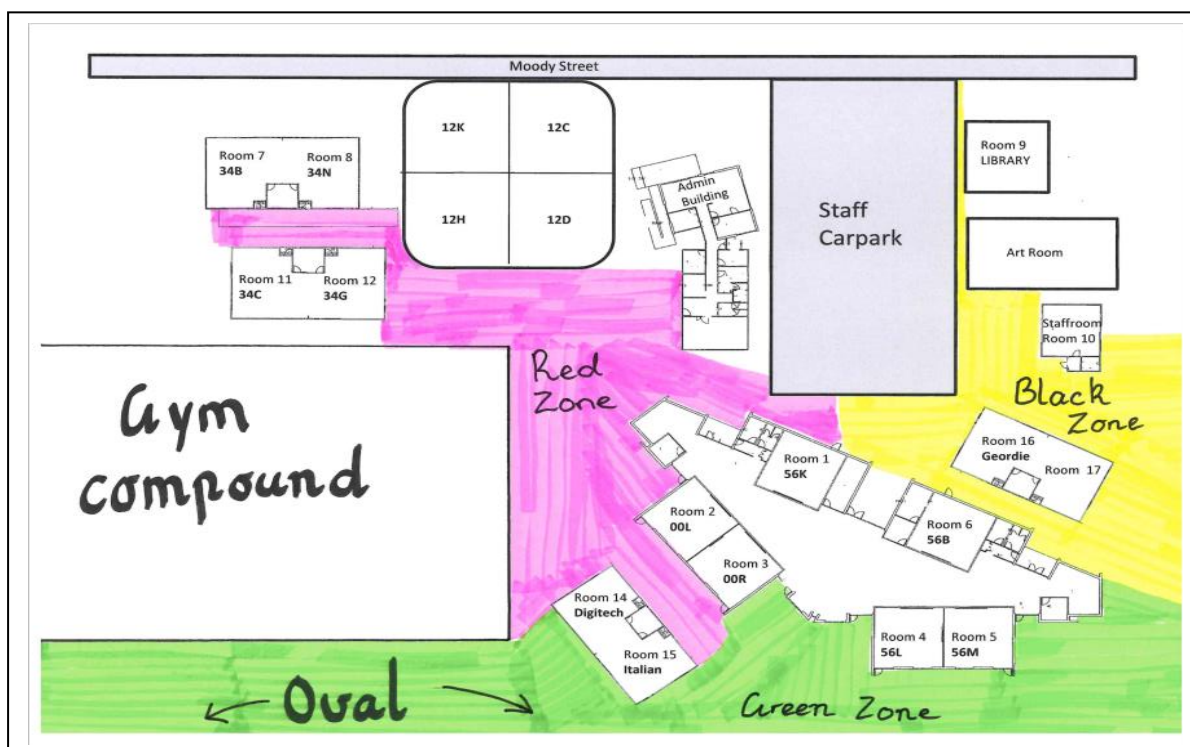

Yard duty equipment

School staff must:

- Wear a provided safety/hi-vis vest whilst on yard duty recess and lunch time duty. Safety/hi-vis vests will be stored in yard duty bags
- Carry the yard duty first aid bag at all times during supervision. Teachers are responsible for the storage of their own yard duty bag
- Be familiar with the yard duty information pack containing student health and safety information stored within the yard duty bag

Yard duty equipment must be returned after the period of supervision or handed to the relieving staff member.

Yard duty responsibilities

Staff who are rostered for yard duty must remain in the designated area until they are replaced by a relieving staff member.

During yard duty, supervising school staff must:

- methodically move around the designated zone ensuring active supervision of all students
- where safe to do so, approach any unknown visitor who is observed on school grounds without a clear legitimate purpose, and ensure they have a visitor lanyard and have signed in at the office (excluding drop off and collection periods)
- be alert and vigilant

YARD DUTY AND SUPERVISION POLICY

- intervene immediately if potentially dangerous or inappropriate behaviour is observed in the yard
- enforce behavioural standards and implement appropriate consequences for breaches of safety rules, in accordance with any relevant disciplinary measures set out in the school's Student Engagement policy and in-line with the Behaviour Matrix
- ensure that students who require first aid assistance receive it as soon as practicable
- log any incidents on Sentral or near misses as appropriate on EduSafe
- wear a hat when on yard duty during recess or lunch time from September 1st to April 30th each year in line with the school's Sun Protection Policy

If being relieved of their yard duty shift by another staff member (for example, where the shift is 'split' into 2 consecutive time periods), the staff member must ensure that a brief but adequate verbal 'handover' is given to the relieving staff member in relation to any issues which may have arisen during the first shift.

If the supervising staff member is unable to conduct yard duty at the designated time, they should contact the daily organiser or the Principal, with as much notice as possible, prior to the relevant yard duty shift to ensure that alternative arrangements are made.

If the supervising staff member needs to leave yard duty during the allocated time, they should contact the office, but should not leave the designated area until the relieving staff member has arrived in the designated area.

If the relieving staff member does not arrive for yard duty, the staff member currently on duty should contact the office to inform they have not been relieved of duty and not leave the designated area until a relieving staff member has arrived.

Students will be encouraged to speak to the supervising yard duty staff member if they require assistance during recess or lunchtime.

Classroom

The classroom teacher is responsible for the supervision of all students in their care during class.

If a student needs to leave the classroom, they should do so in pairs.

If a teacher needs to leave the classroom unattended at any time during a lesson, they should first contact the teacher in the room next door for assistance. If the classroom does not have a teacher in the room next door, they should contact the office and then wait until a replacement staff member has arrived at the classroom before leaving.

School activities, camps and excursions

The Principal and Leadership Team are responsible for ensuring that students are appropriately supervised during all school activities, camps and excursions, including when external providers are engaged to conduct part or all of the activity. Appropriate supervision will be planned for school activities, camps and excursions on an individual basis, depending on the activities to be undertaken and the level of potential risk involved, and will follow the supervision requirements in the Department of Education and Training [Excursions Policy](#).

Digital devices and virtual classroom

Koo Wee Rup Primary School follows the Department's [Cybersafety and Responsible Use of Technologies Policy](#) with respect to supervision of students using digital devices.

Koo Wee Rup Primary School will also ensure appropriate supervision of students participating in remote and flexible learning environments while on school site. In these cases, students will be supervised in a common area; either a classroom or the BER shared space, dependant upon numbers.

While parents are responsible for the appropriate supervision of students accessing virtual classrooms from home:

- student attendance will be monitored by the child's teacher via attendance at a Reconnection Time session and the submission of assigned learning tasks
- any wellbeing or safety concerns for the student will be managed in accordance with our usual processes – refer to our Student Wellbeing and Engagement Policy and our Child Safety Responding and Reporting Policy and Procedures for further information.

Students requiring additional supervision support

Sometimes students will require additional supervision, such as students with disability or other additional needs. In these cases, the Principal or delegate will ensure arrangements are made to roster additional staff as required. This may include on yard duty, in the classroom or during school activities.

Supervision of student in emergency operating environments

In emergency circumstances our school will follow our Emergency Management Plan, including with respect to supervision.

In the event of any mandatory period of remote or flexible learning our School will follow the operations guidance issued by the Department.

COMMUNICATION

This policy will be communicated to our school community in the following ways:

- made publicly available via the school website
- included in staff induction processes
- discussed at staff briefings or meetings, as required
- made available in hard copy from the school office

Information for parents and students on supervision before and after school is available on our school website and parent reminders are sent periodically each term in our school newsletter.

FURTHER INFORMATION AND RESOURCES

- the Department's Policy and Advisory Library (PAL):
 - [Child Safe Standards](#)
 - [Cybersafety and Responsible Use of Technologies](#)
 - [Duty of Care](#)
 - [Excursions](#)
 - [Supervision of Students](#)



YARD DUTY AND SUPERVISION POLICY

- [Visitors in Schools](#)

POLICY REVIEW AND APPROVAL

Policy last reviewed	February 2024
Approved by	Principal
Next scheduled review date	February 2026

This policy will also be updated if significant changes are made to school grounds that require a revision of Koo Wee Rup Primary School's yard duty and supervision arrangements.